

SEZIONE A-A

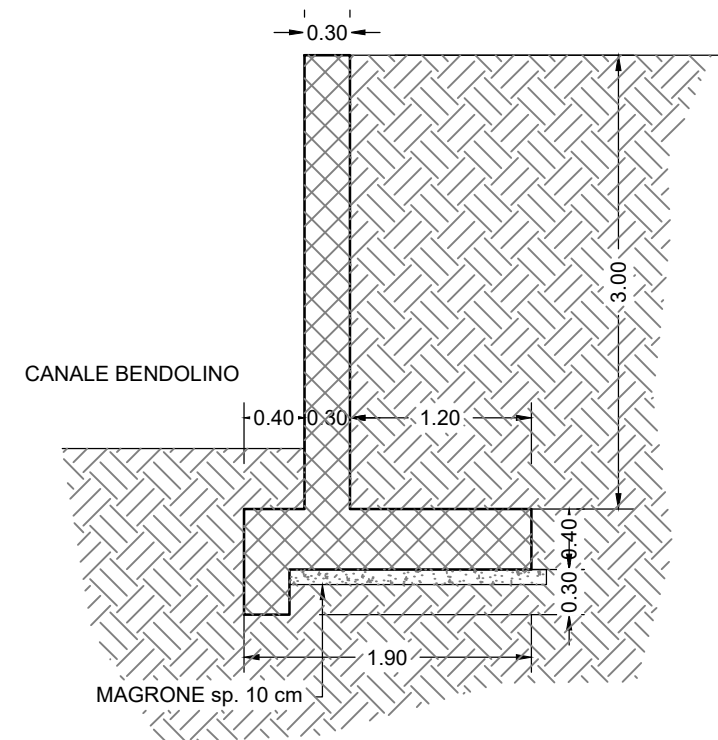

SEZIONE B-B

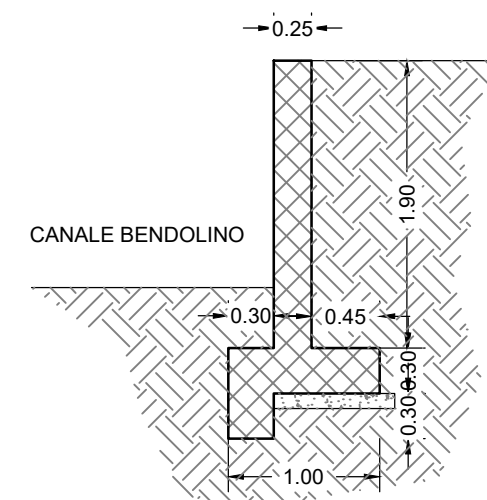

SEZIONE C-C

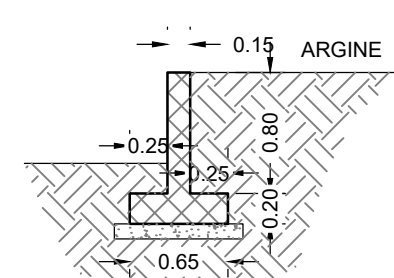

SEZIONE D-D

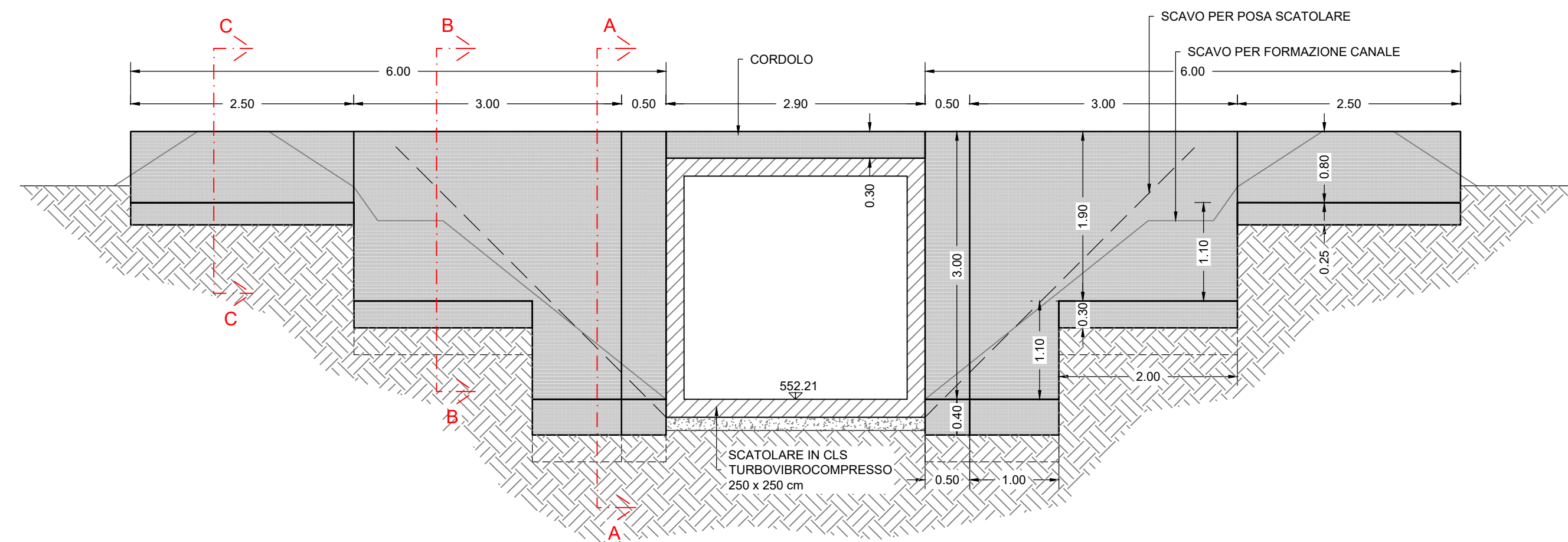

PLANIMETRIA

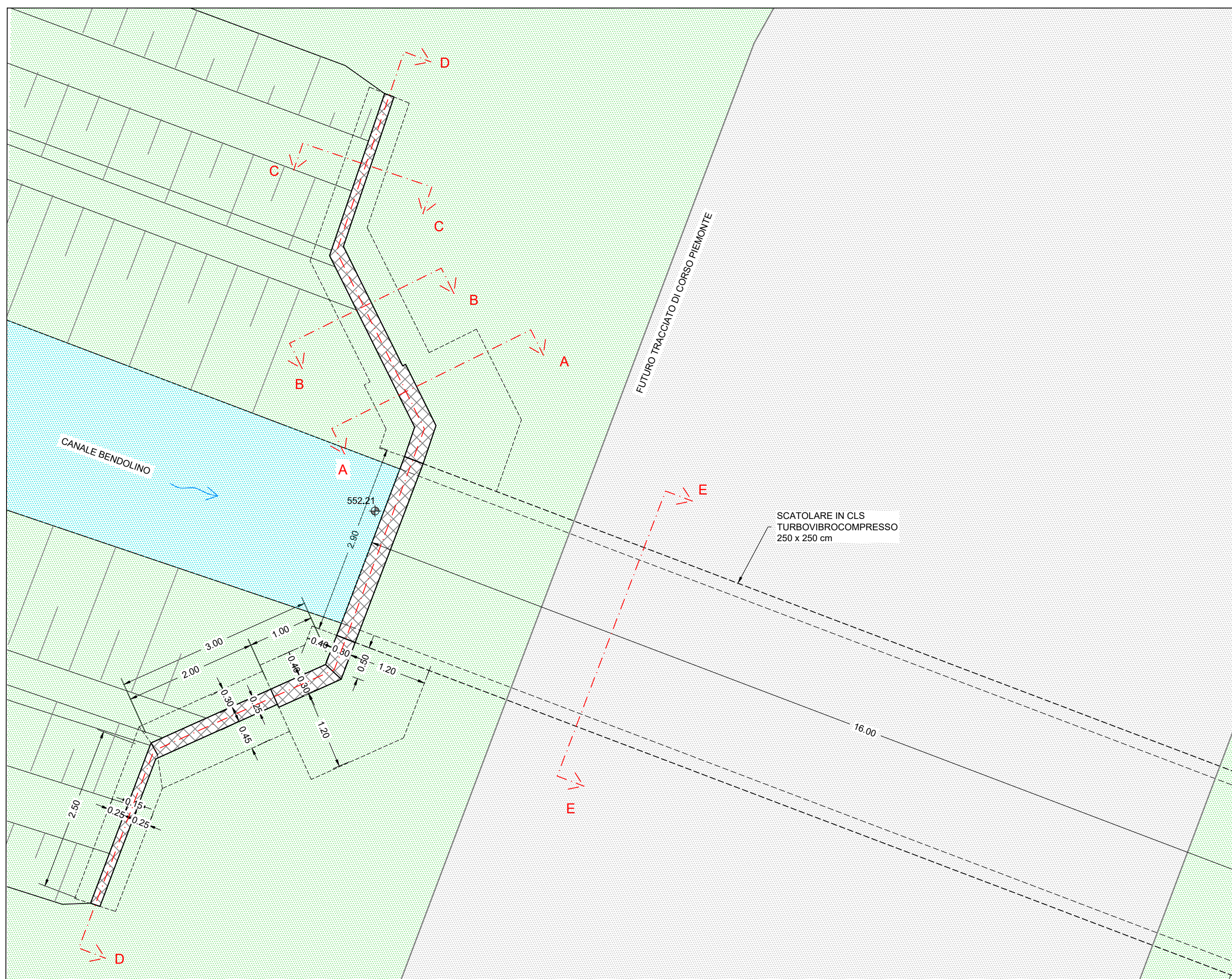

SEZIONE E-E

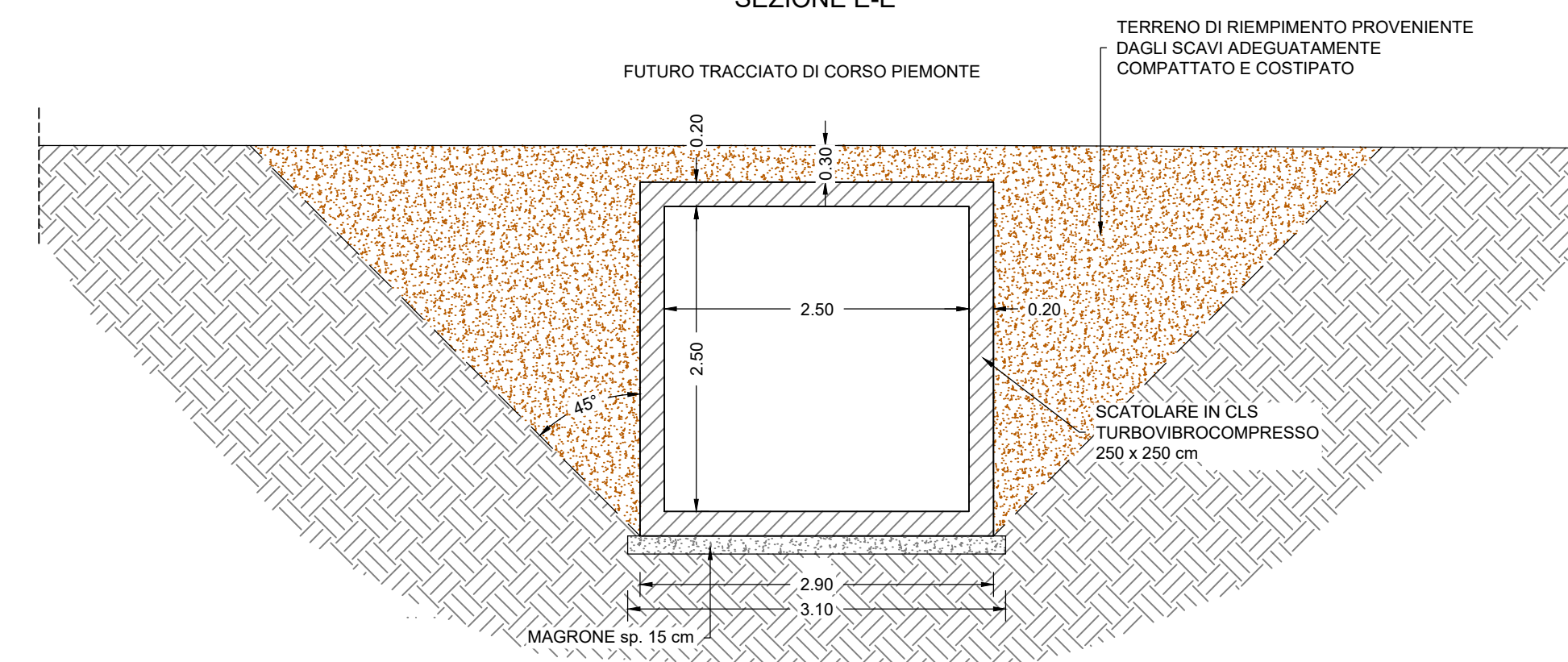

SEZIONE F-F

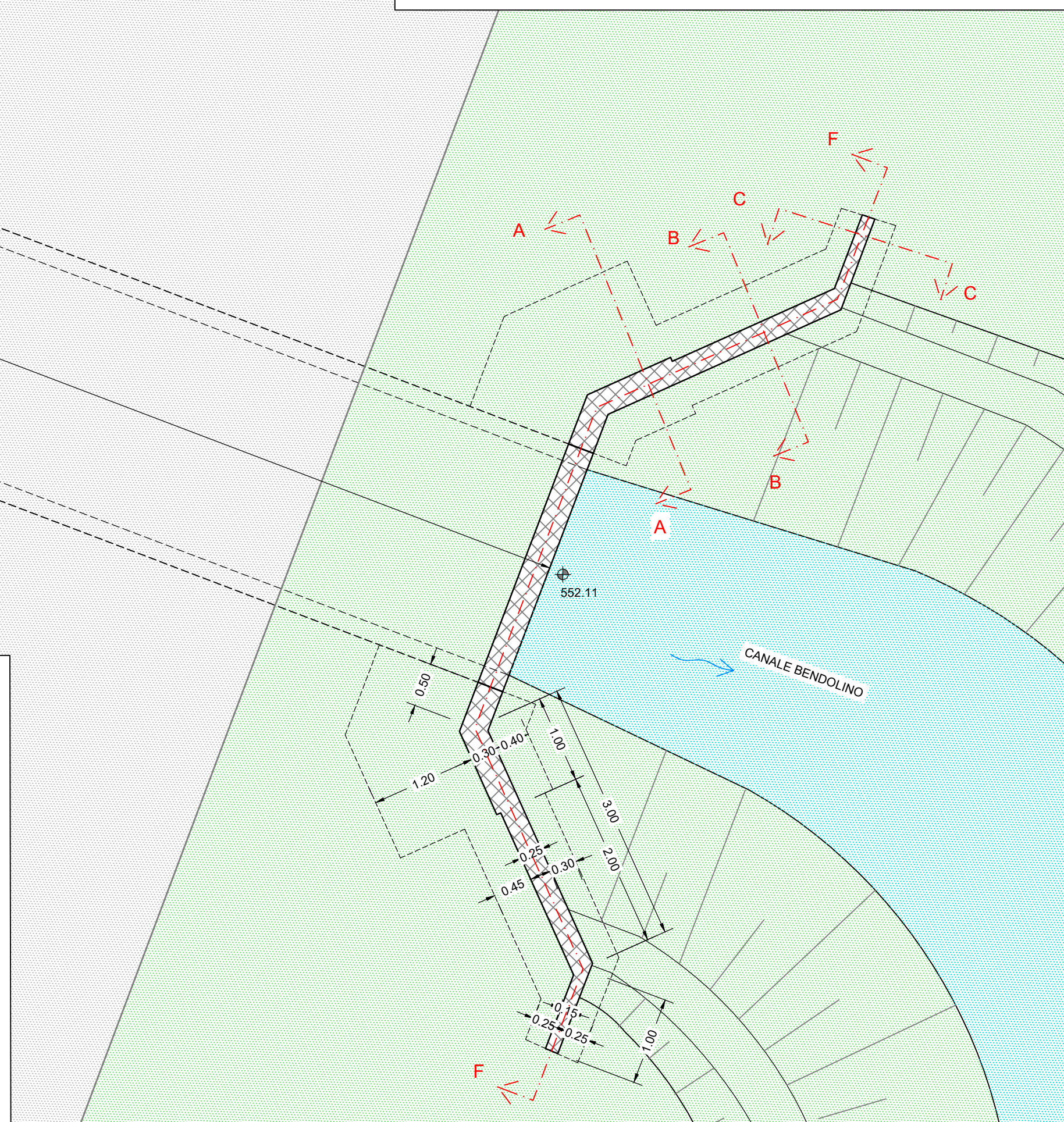
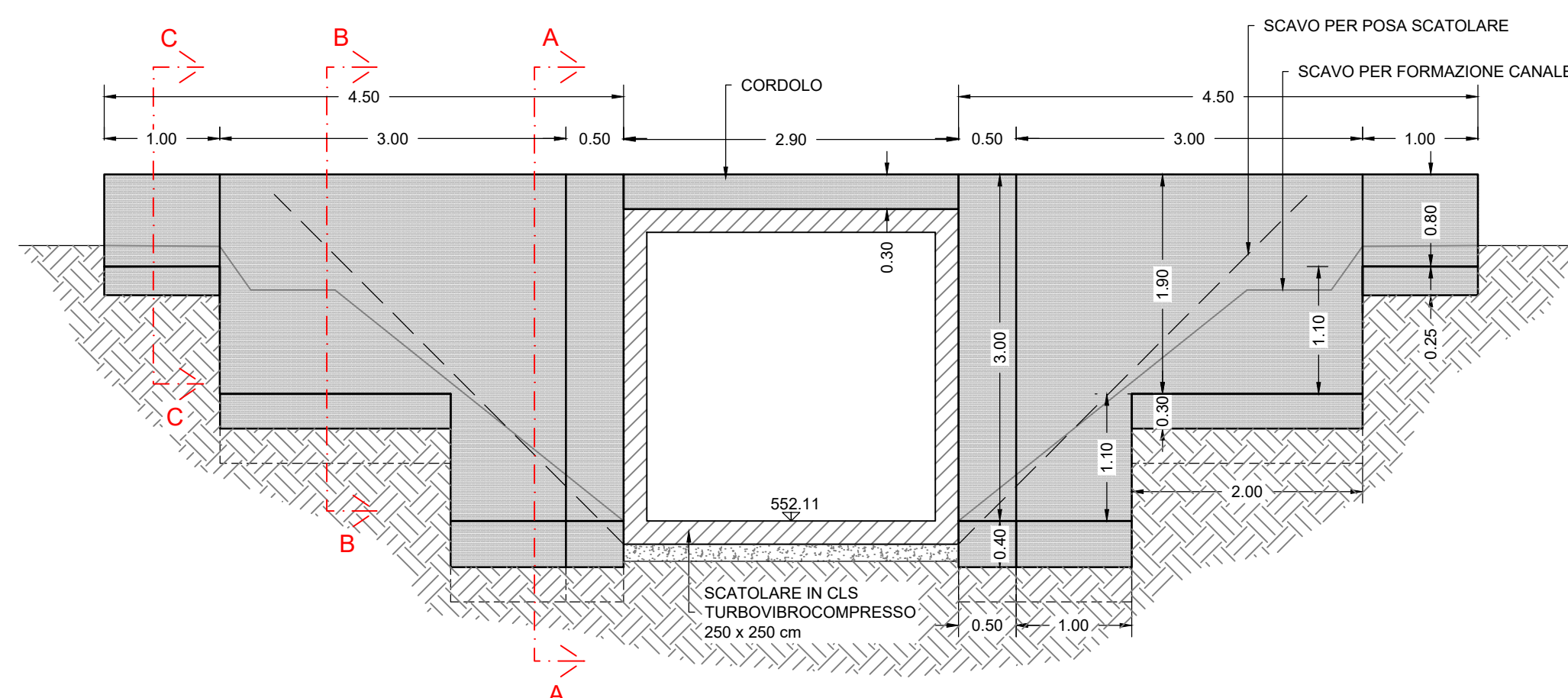

Regione Piemonte

Città Metropolitana di Torino



COMUNE DI VOLPIANO

LAVORI DI URBANIZZAZIONE IN AREE CASCINA VERDINA -  
TRASLAZIONE CANALE BENDOLINO

PROGETTO DEFINITIVO

RESPONSABILE DEL PROCEDIMENTO

COMMITTENTE

PARTICOLARI COSTRUTTIVI SCATOLARE CORSO PIEMONTE

Elaborato	Scala
11	1:50

CODICE:  
17029-D10-0

REVISIONE	DATA
0	APR.2020



PROGETTISTI:  
Dott. Ing. Bartolomeo VISCONTI  
Dott. Ing. Luca GATTIGLIA  
Dott. Ing. Chiara PALESE

EDes Ingegneri Associati P.IVA 1075975010  
Via Postumia 49, 10142 Torino Tel. +39 011.0262900 Fax. +39 011.0262902  
www.edesconsulting.eu edes@edesconsulting.eu